

# **FARAD<sup>®</sup> BARS**

made in italy

## **BS 137 - 1**

FORD KA+ 2016>

5

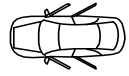

<b>I</b>	Istruzioni di montaggio	<b>F</b>	Instructions de montage
<b>PL</b>	Instrukcja montażu	<b>D</b>	Einbauanleitung
<b>GB</b>	Fitting instructions	<b>E</b>	Instrucciones de montaje
<b>NL</b>	Inbouwhandleiding	<b>SWE</b>	Montageanvisnin

# KIT BS

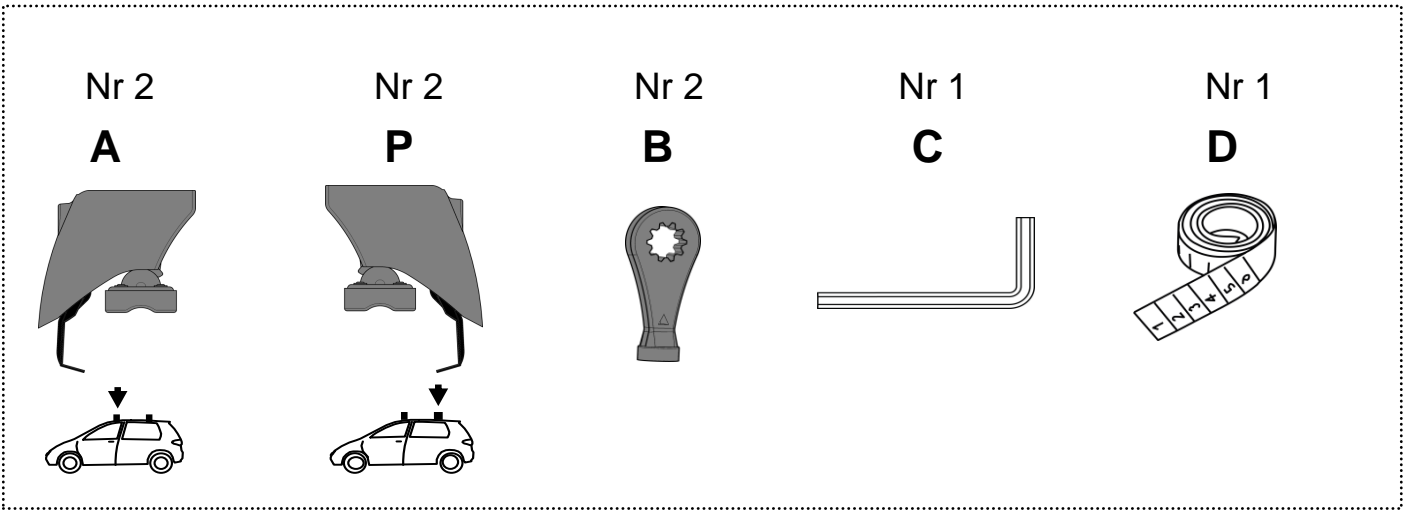

+

# KIT ALU

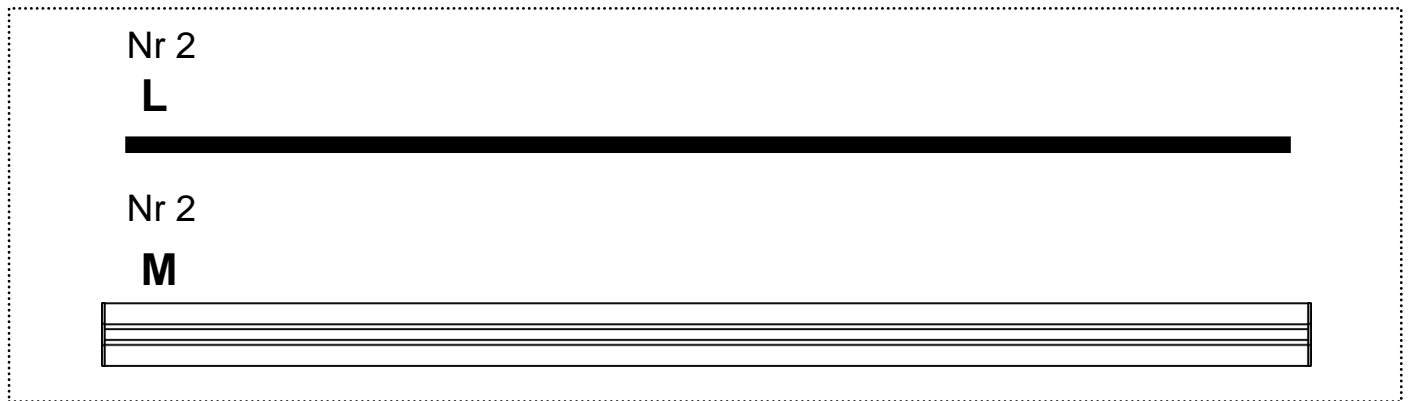

=

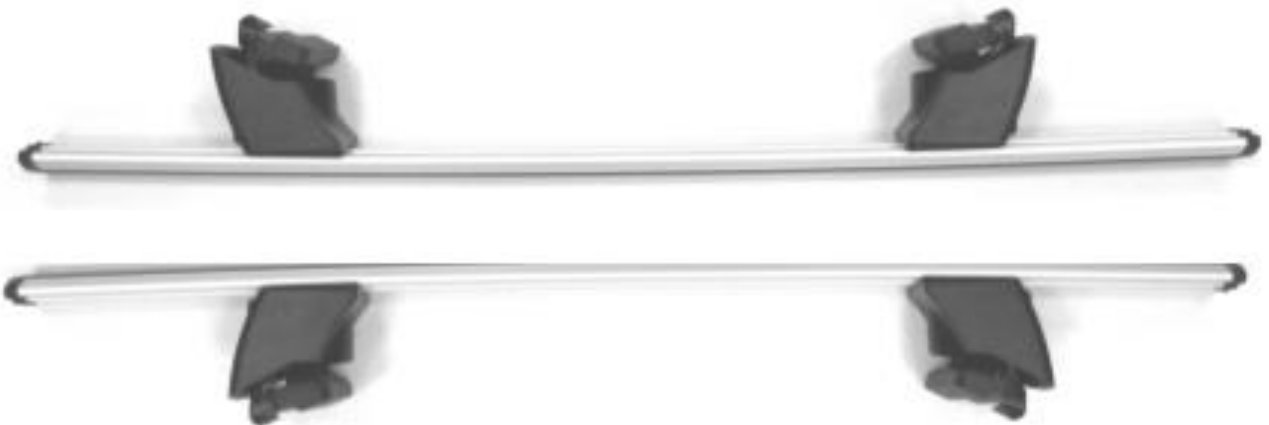

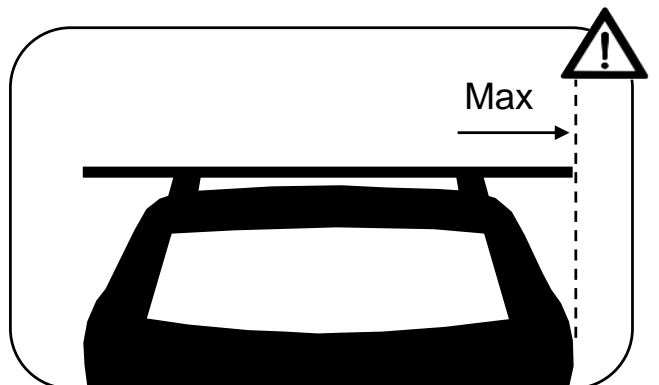
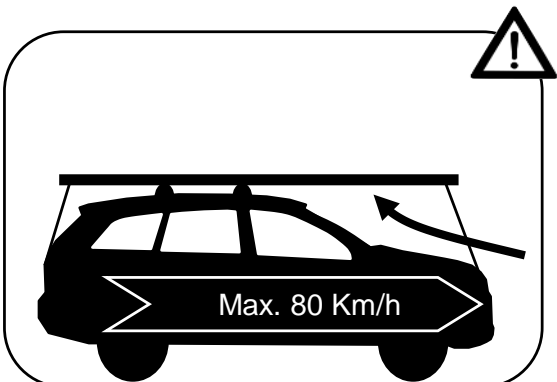
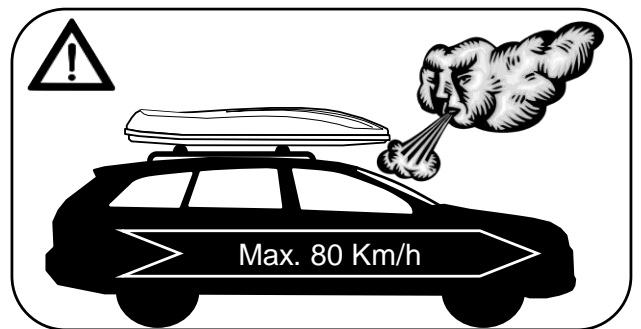
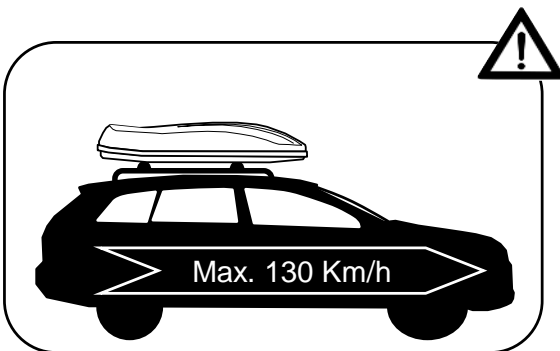
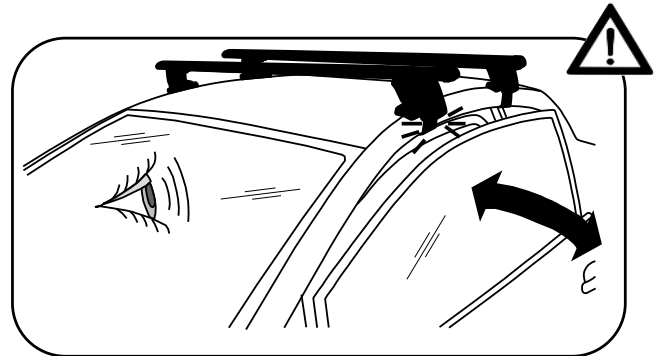
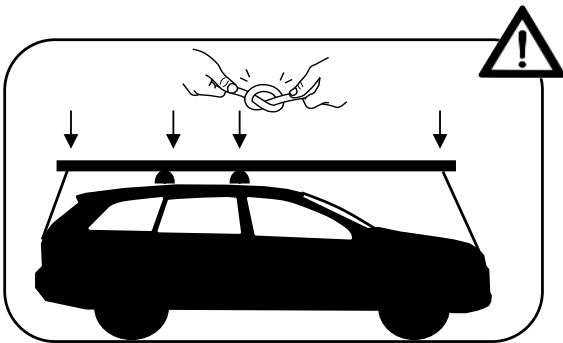
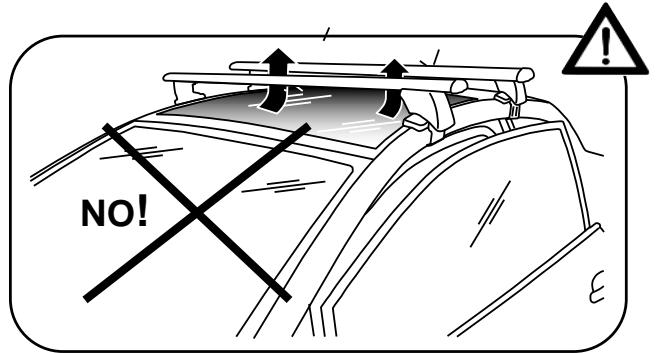
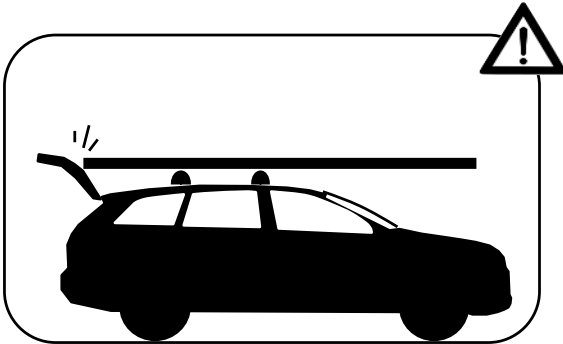
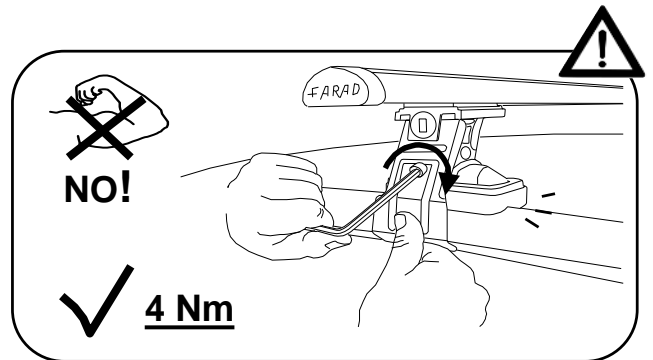
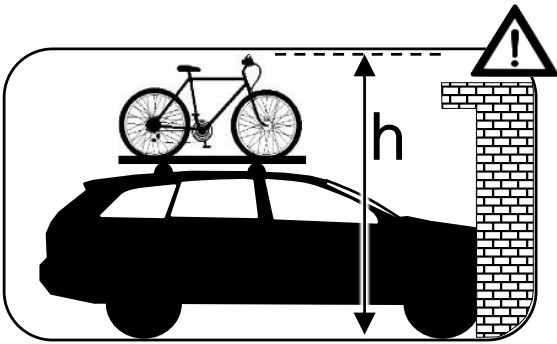

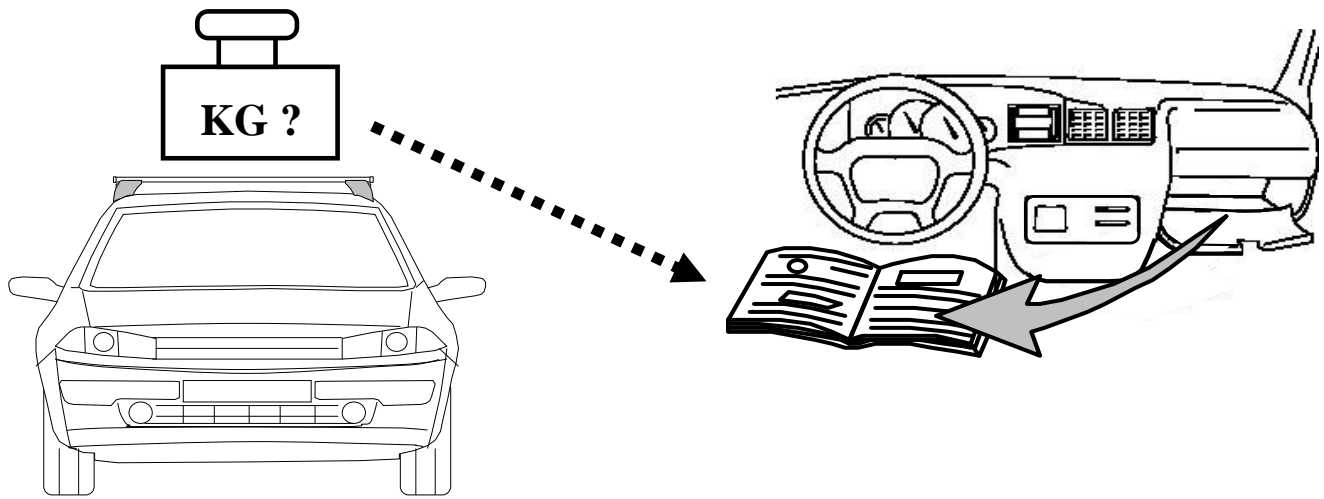

- I Controllare carico del tetto sul manuale dell'auto
- PL Sprawdź ładowność dachu w instrukcji
- GB Check roof load capacity in car instruction
- NL check de handleiding belasting van het dak van de auto
- F vérifier le chargement manuel du toit de la voiture
- D überprüfen Sie die manuelle Beladung der Autodach
- E comprobar la carga manual del techo del coche
- SWE kontrollera manuell inläggning på taket av bilen

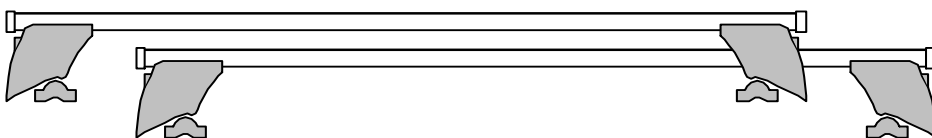
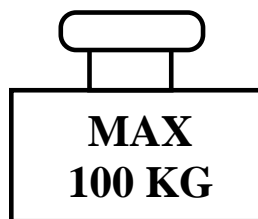
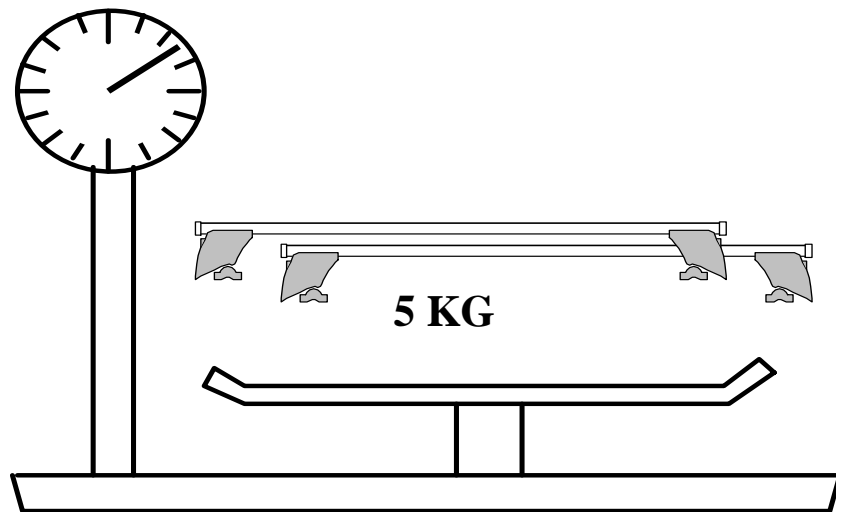

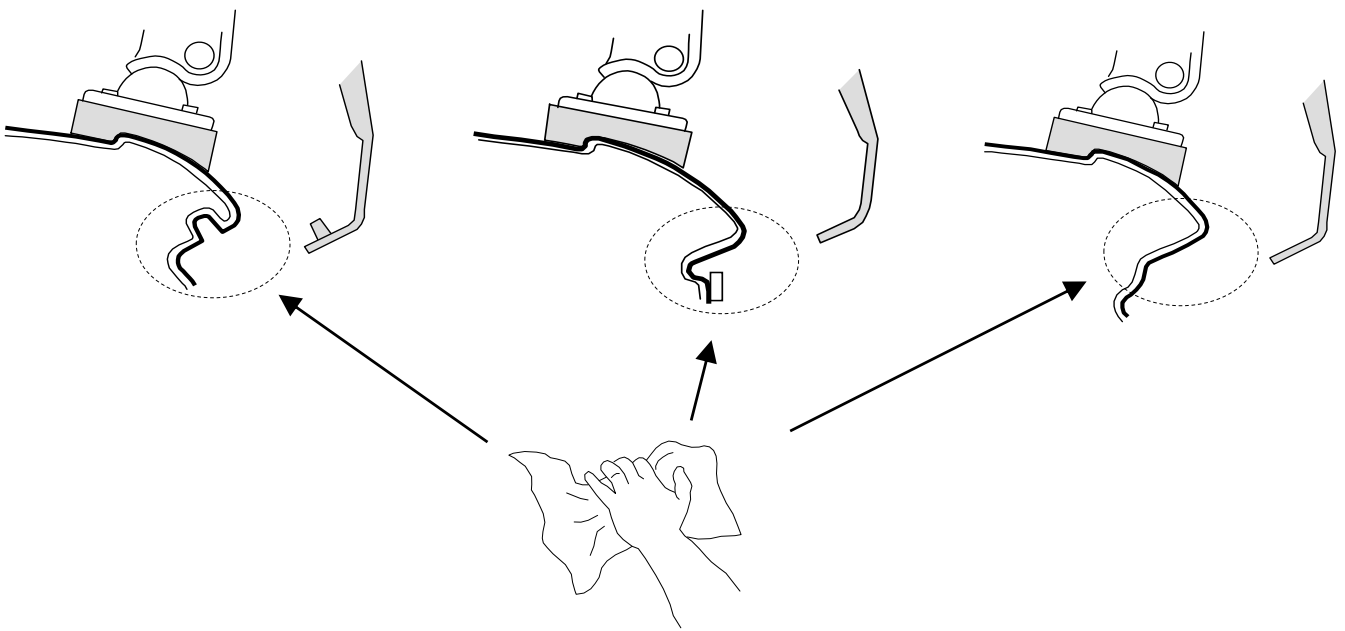
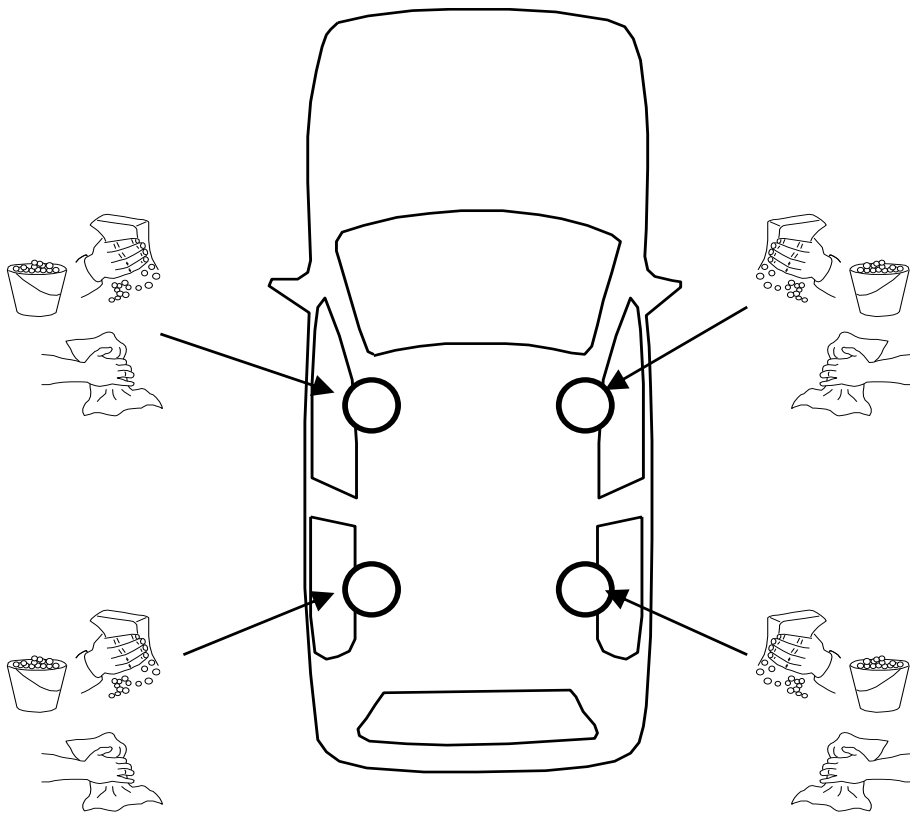

I Montaggio Barra Anteriore

F Fixation Barre Avant

PL Montaż Bagażnika Bazowego Tylnego

GB Fitting Front Roof Bar

D Montage Vorderes Dachträgers

NL Montage Voorste Dakdrager

SWE Montering Av Främre Lasthållaren

E Fijación Barra Frontal

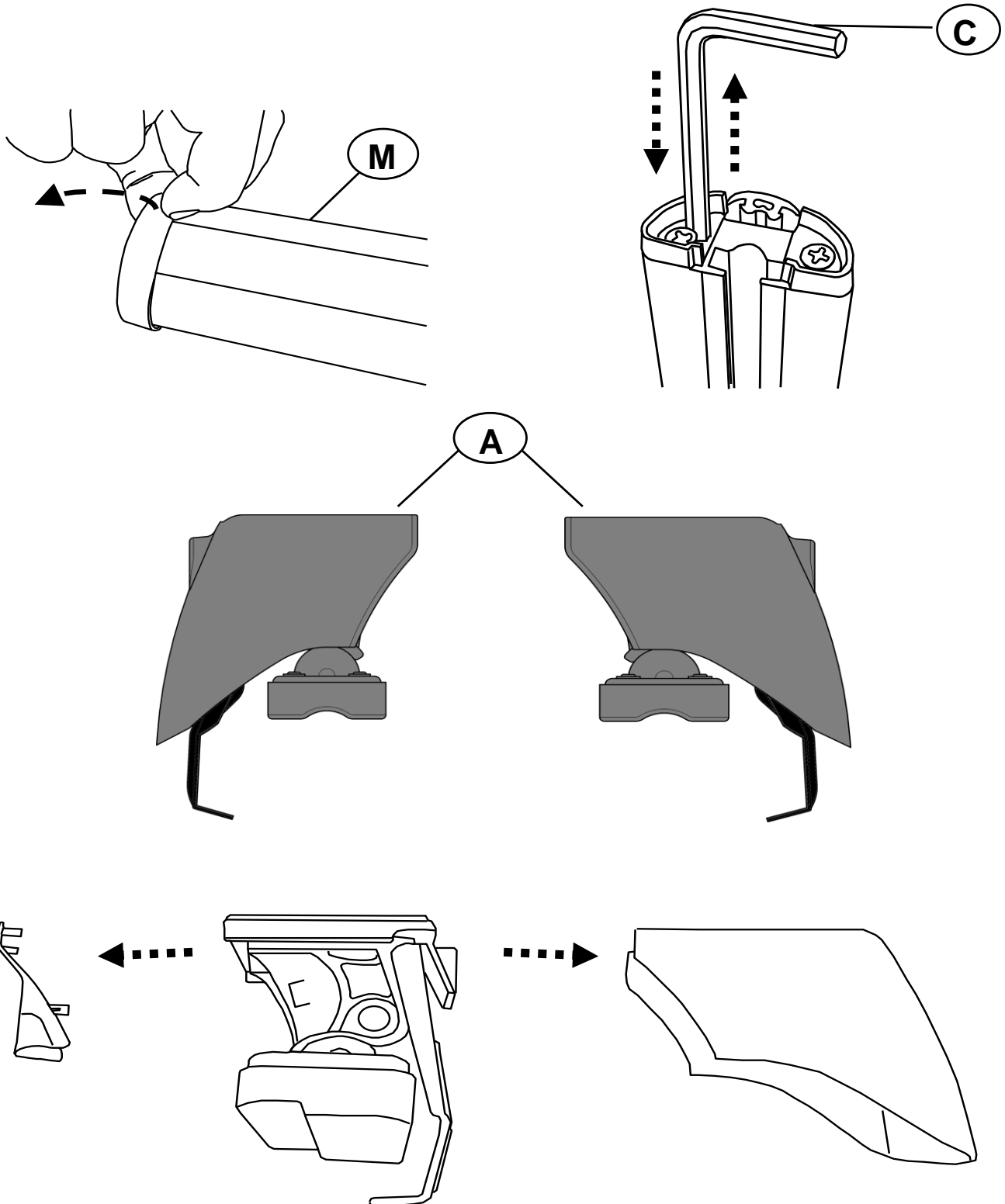



M

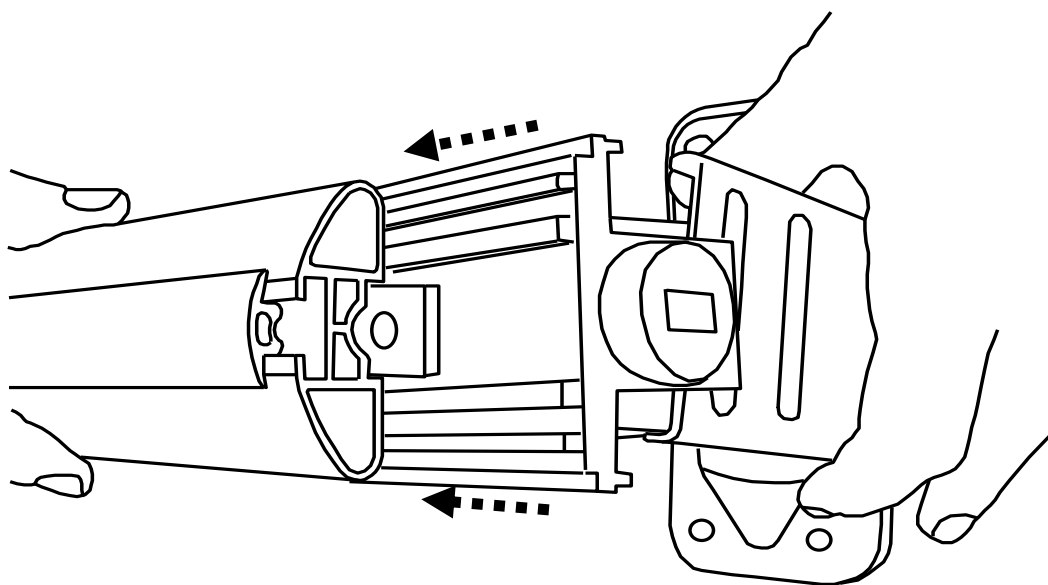
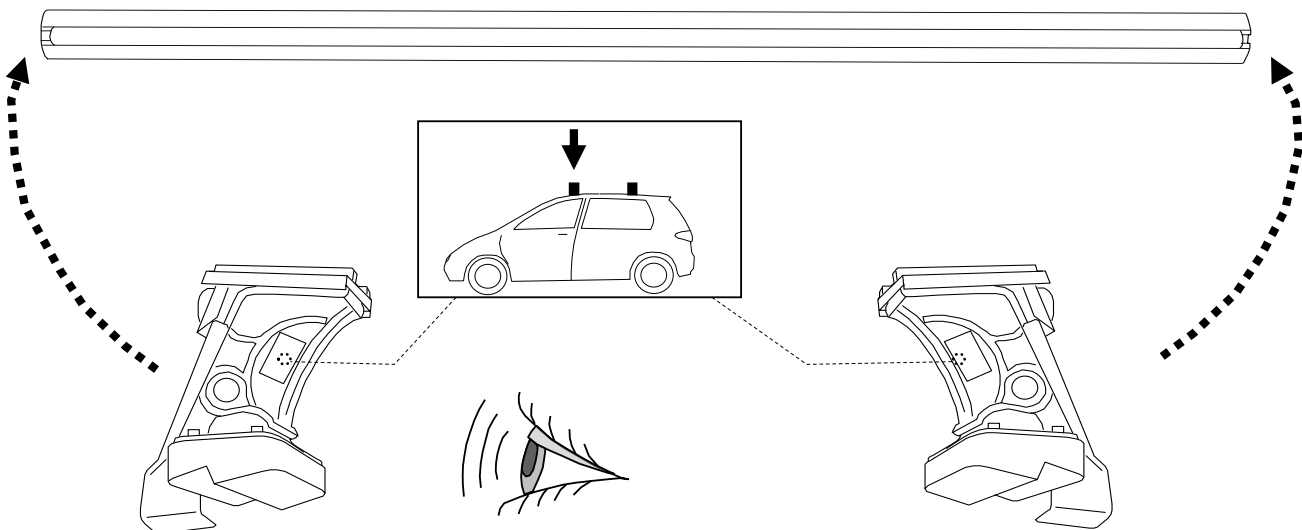

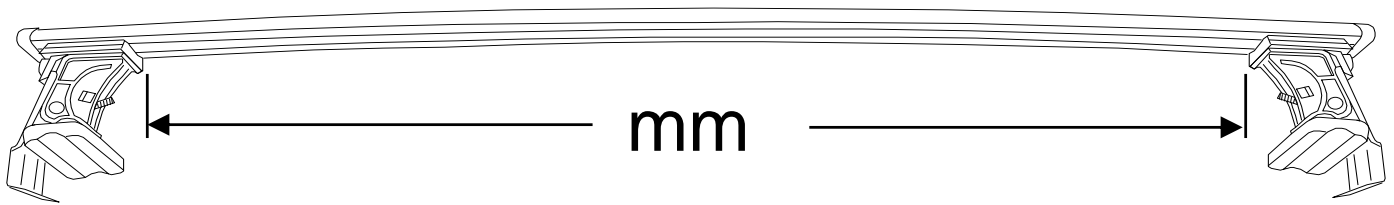

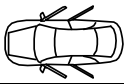
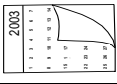

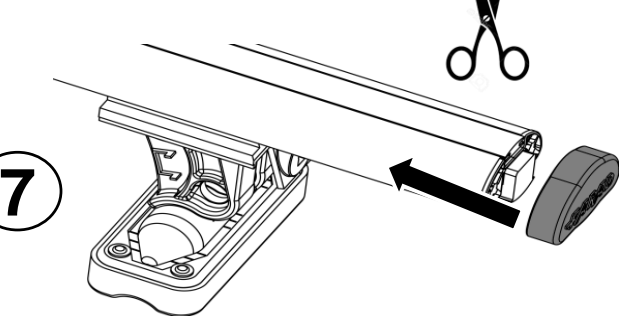
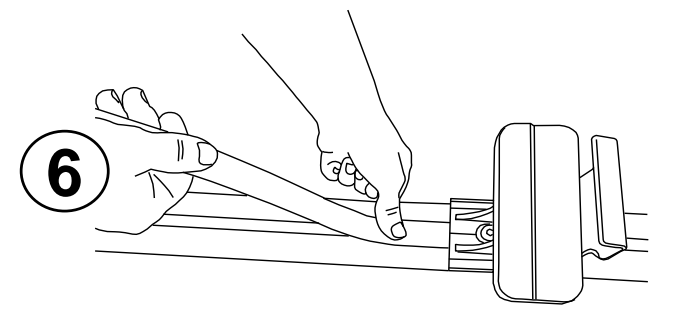
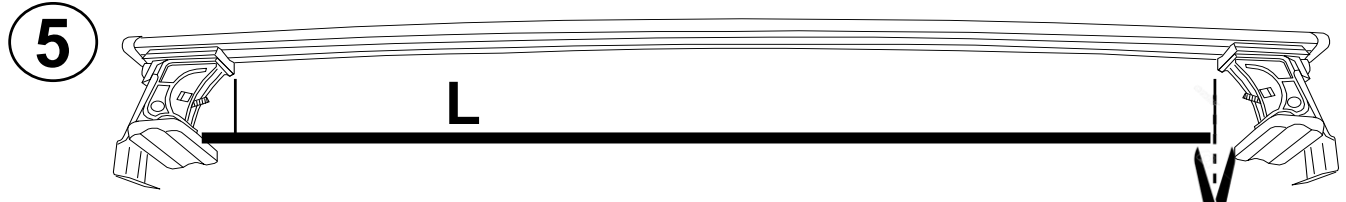
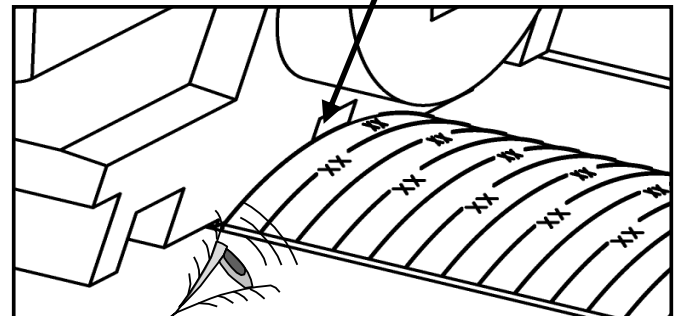
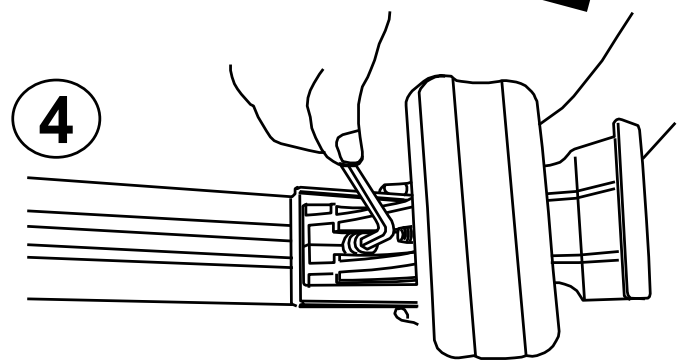
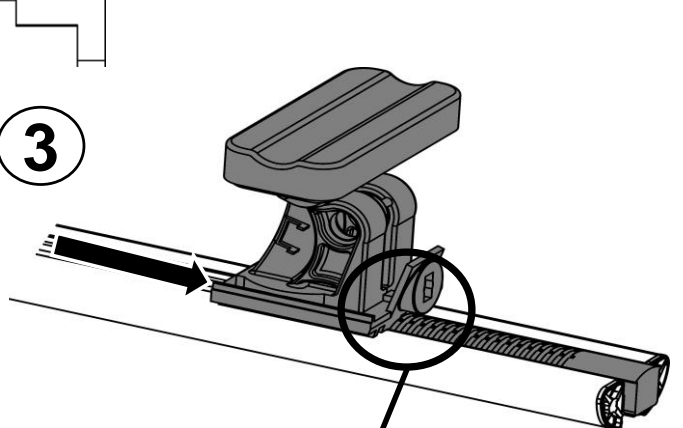
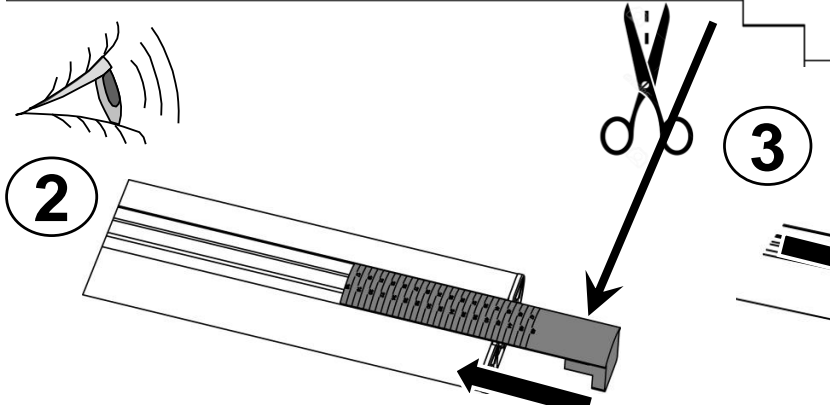
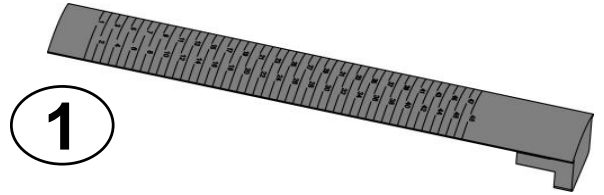
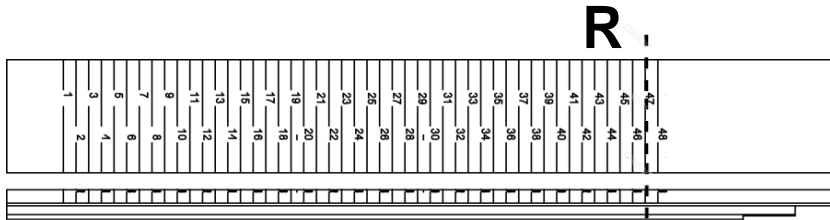
			<b>R</b>	<b>mm</b>
<b>FORD</b>	<b>KA+</b>	<b>5</b>	<b>R= 47</b>	<b>1000</b>



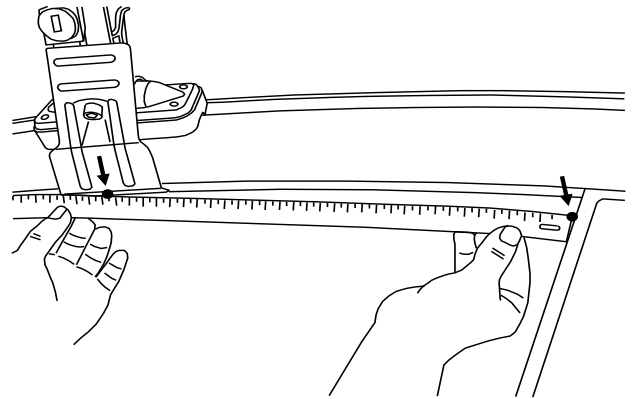
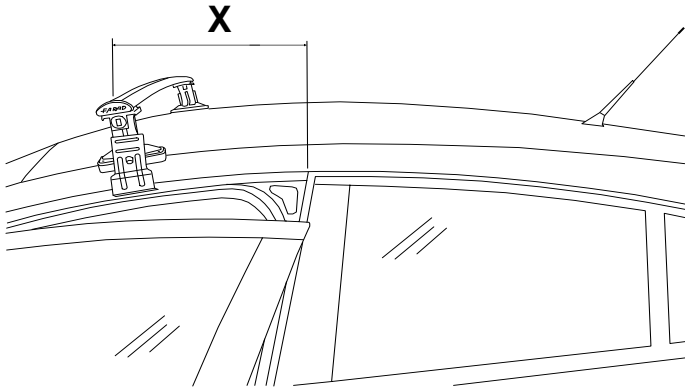
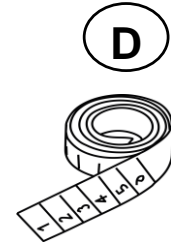
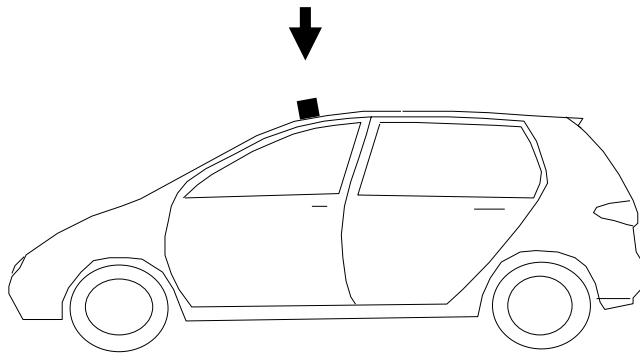

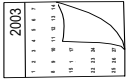

			<b>X</b>
<b>FORD</b>	<b>KA+</b>	<b>5</b>	<b>X= 280</b>

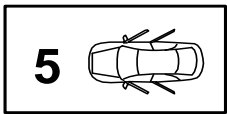

✓ 4 Nm

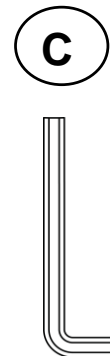
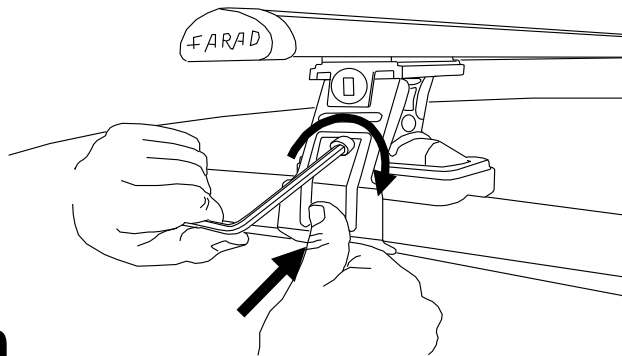

<b>REV 001</b>	<b>12/10/2018</b>	<b>9 / 20</b>
----------------	-------------------	---------------

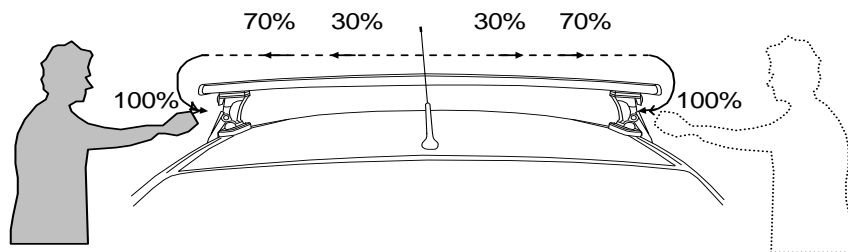

- |    |   |     |                                    |
|----|---|-----|------------------------------------|
| I  | Alternare il fissaggio delle viti                       | F   | Serrer alternativement chaque côté |
| PL | Śruby dokręcaj naprzemiennie                            | D   | Die Schrauben abwechselnd anziehen |
| GB | Tighten alternately                                     | E   | Apretar alternativamente           |
| NL | Afwisselend aan de linker- en de rechterkant aandraaien | SWE | Dra åt växelvis                    |

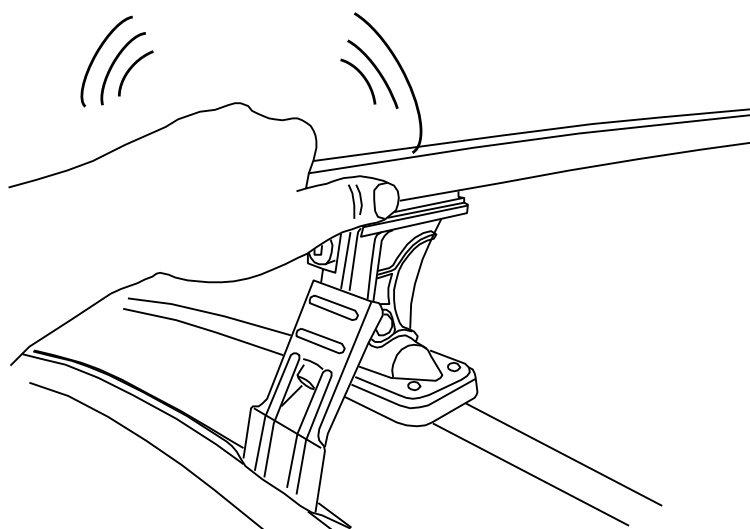
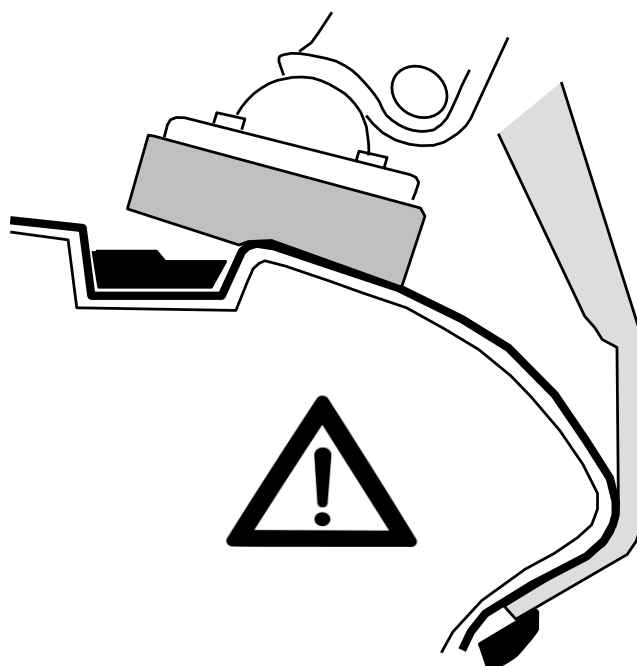
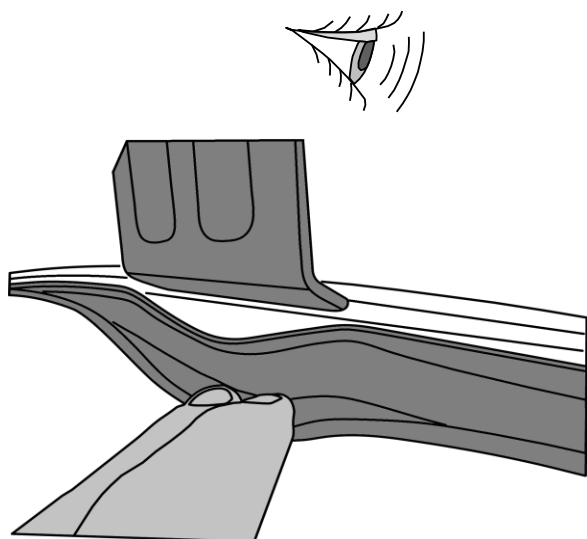
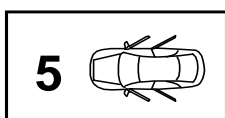

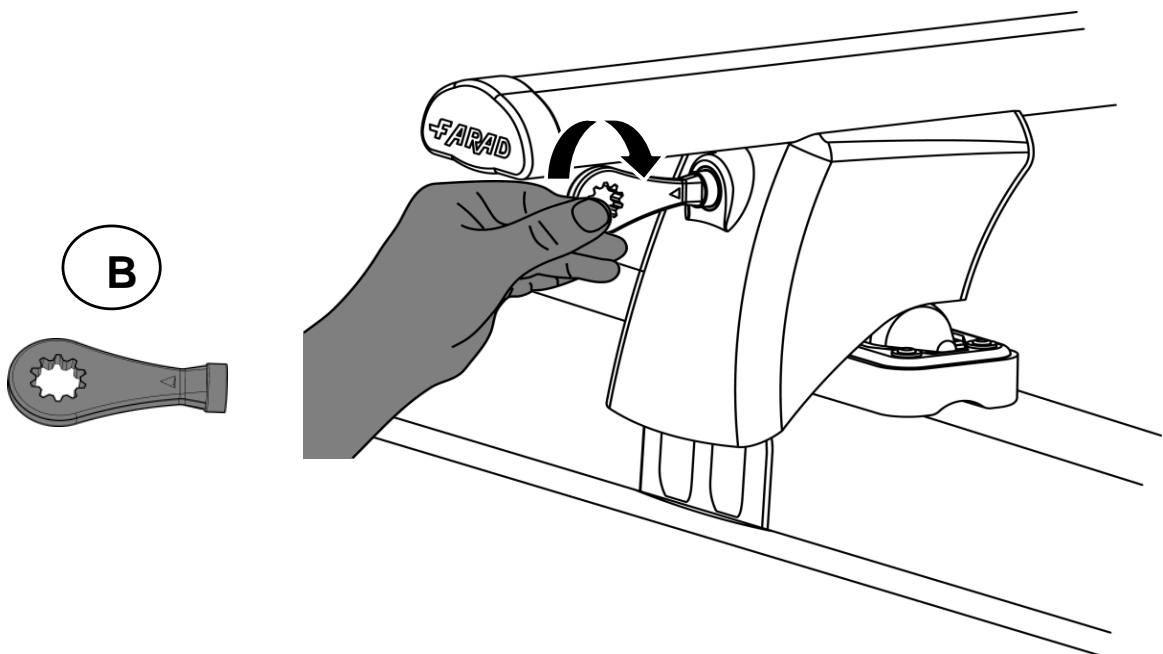
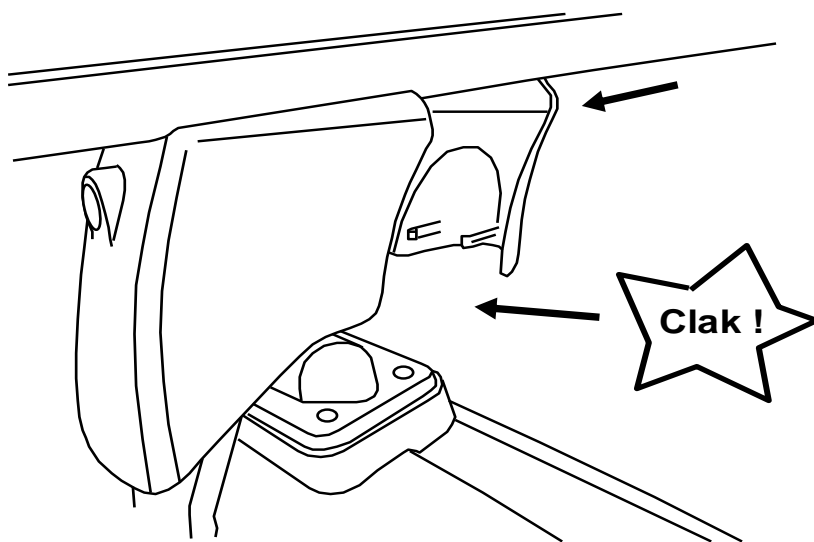
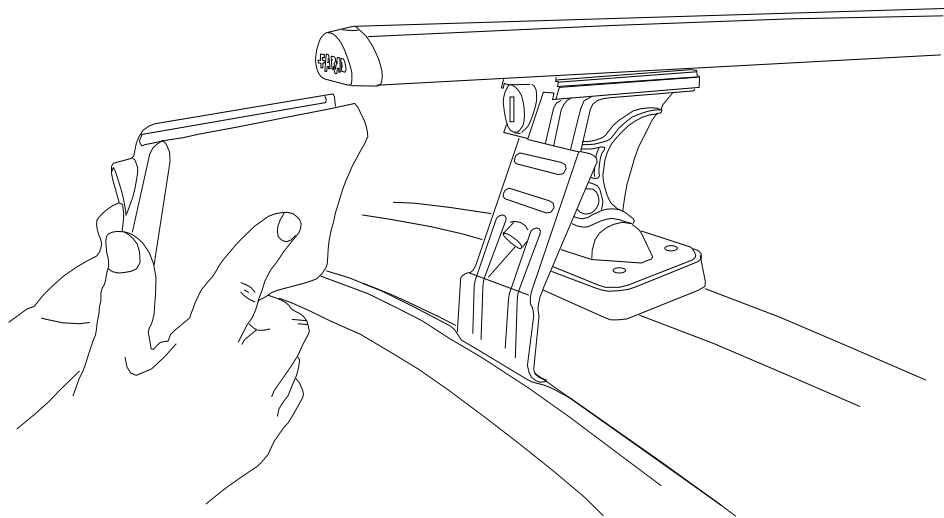

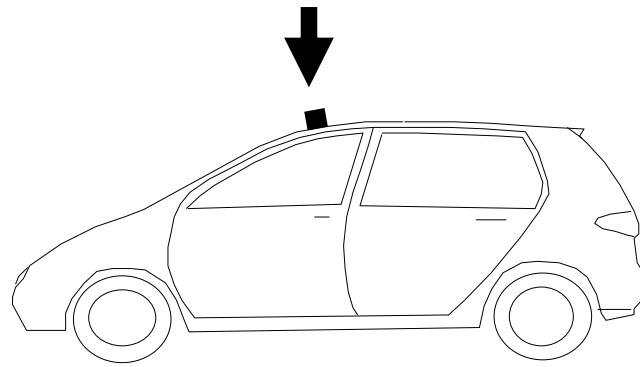

- I** CONTROLLARE PERIODICAMENTE IL FISSAGGIO DELLE VITI
- PL** OKRESOWO SPRAWDZAJ MOCOWANIE ŚRUB
- GB** CHECK THE SCREW FASTENING PERIODICALLY
- D** REGELMÄSSIG ÜBERPRÜFEN DIE BEFESTIGUNG DER SCHRAUBEN
- SWE** REGELBUNDET KONTROLLERA OM FASTSTÄLLANDE AV SKRUVARNA
- F** VERIFIEZ LA FIXATION DES VIS PERIODIQUEMENT

I Montaggio barra posteriore

PL Montaż Bagażnika Bazowego Przedniego

SWE Montering Främre Lasthållaren

NL Montage Achterste Dakdrager

F Fixation Barre Arriere

GB Fitting Rear Roof Bar

E Fijación Barra Trasera

D Montage Heckdachträgers

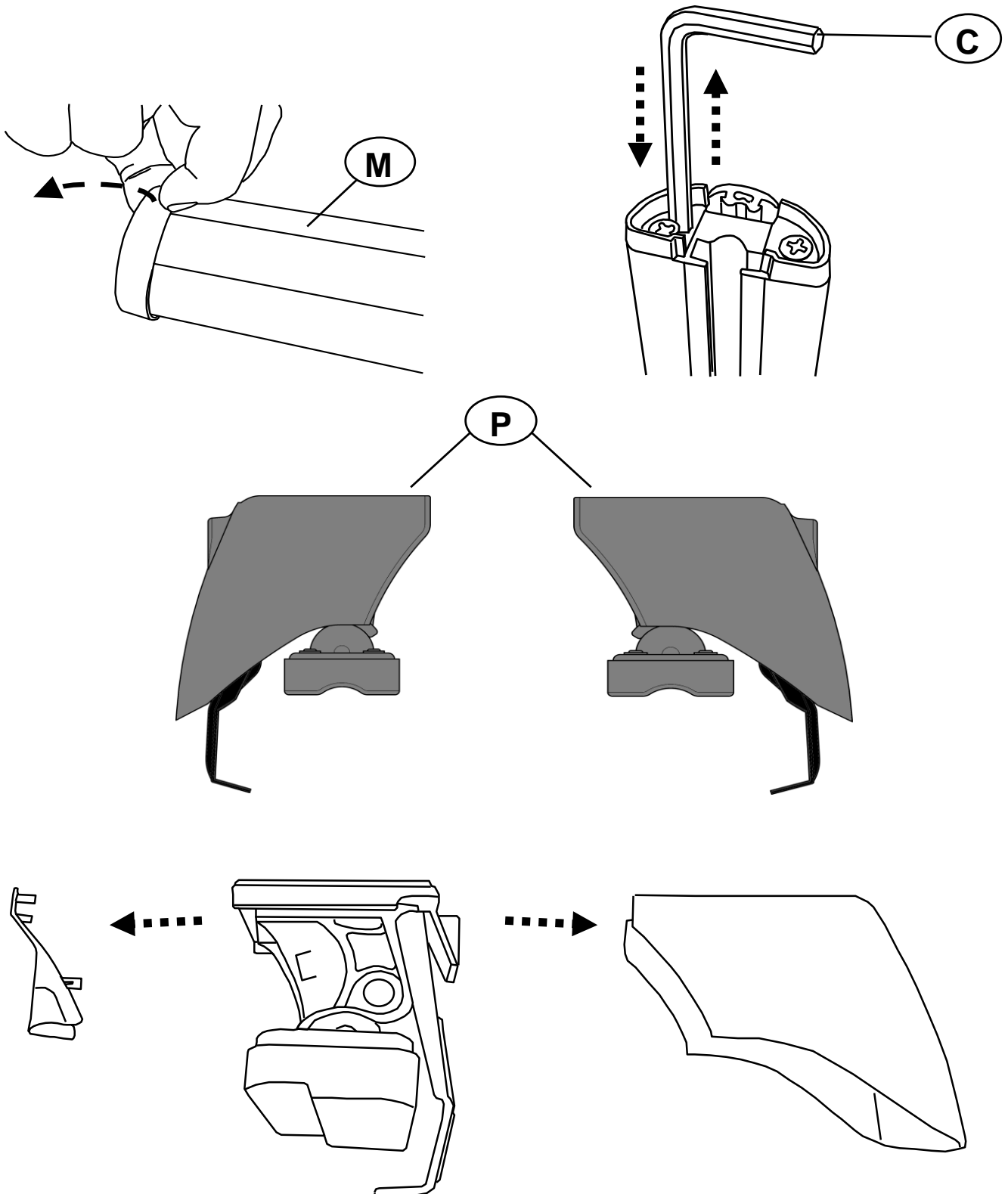



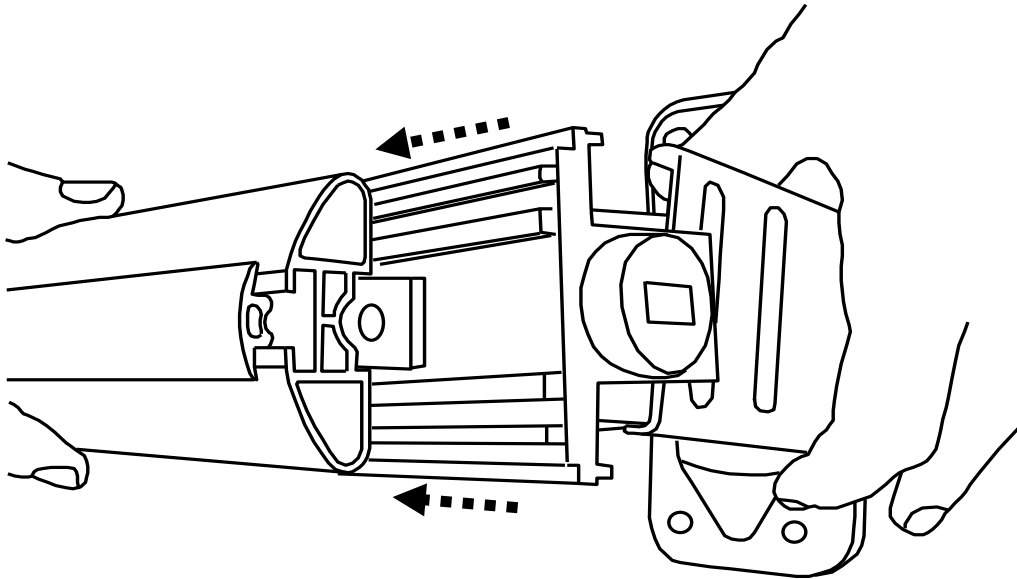
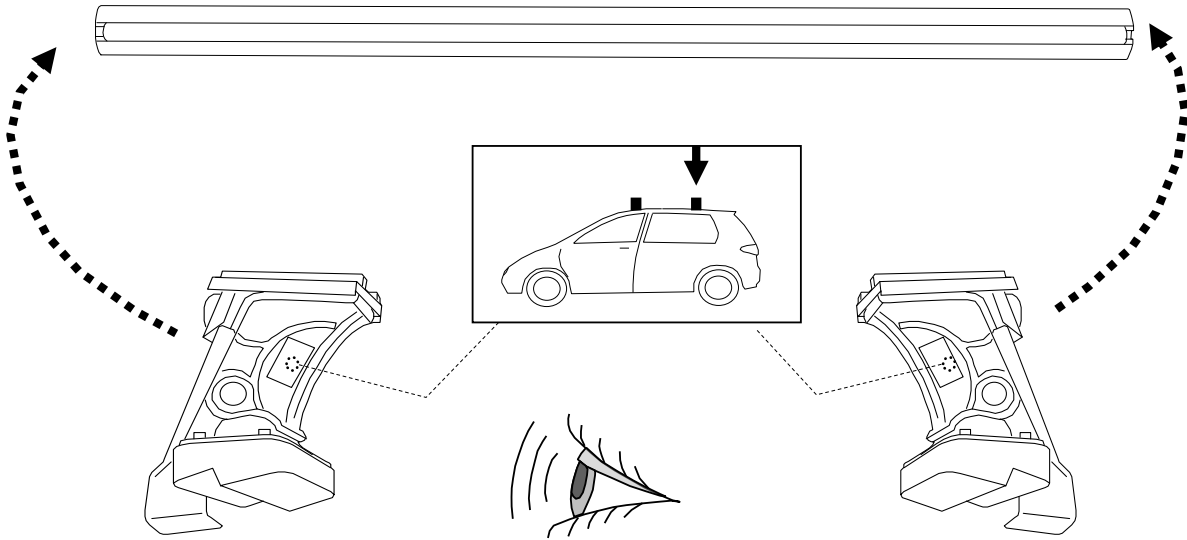

M

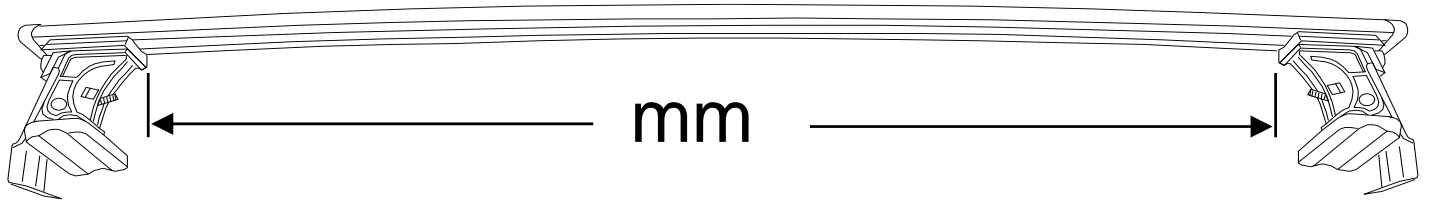



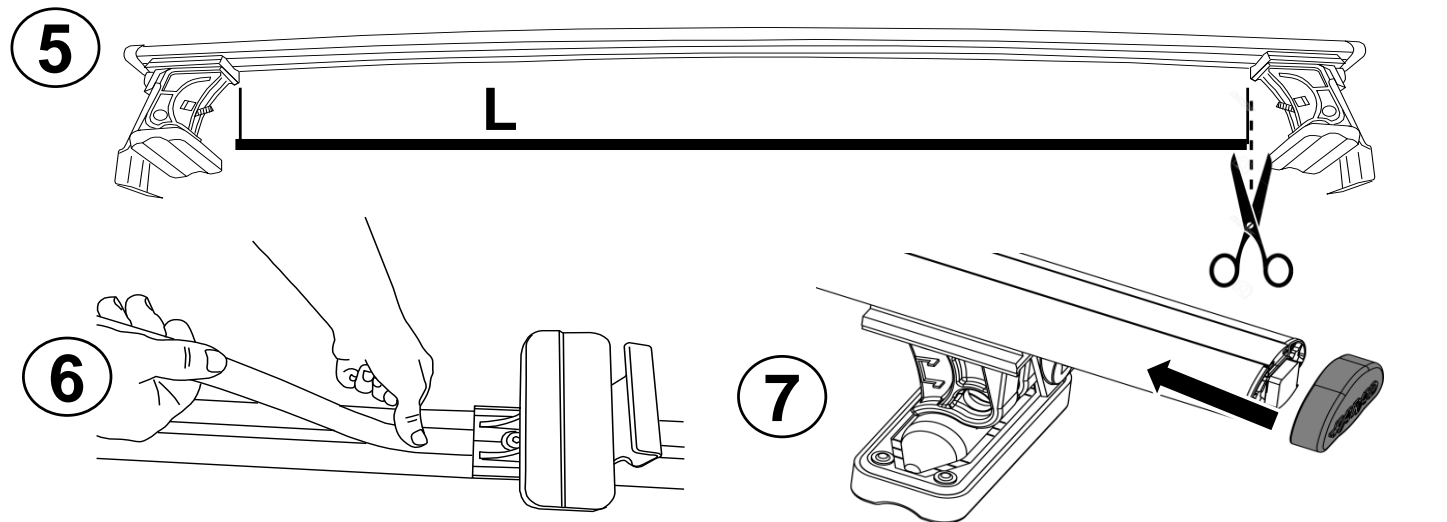
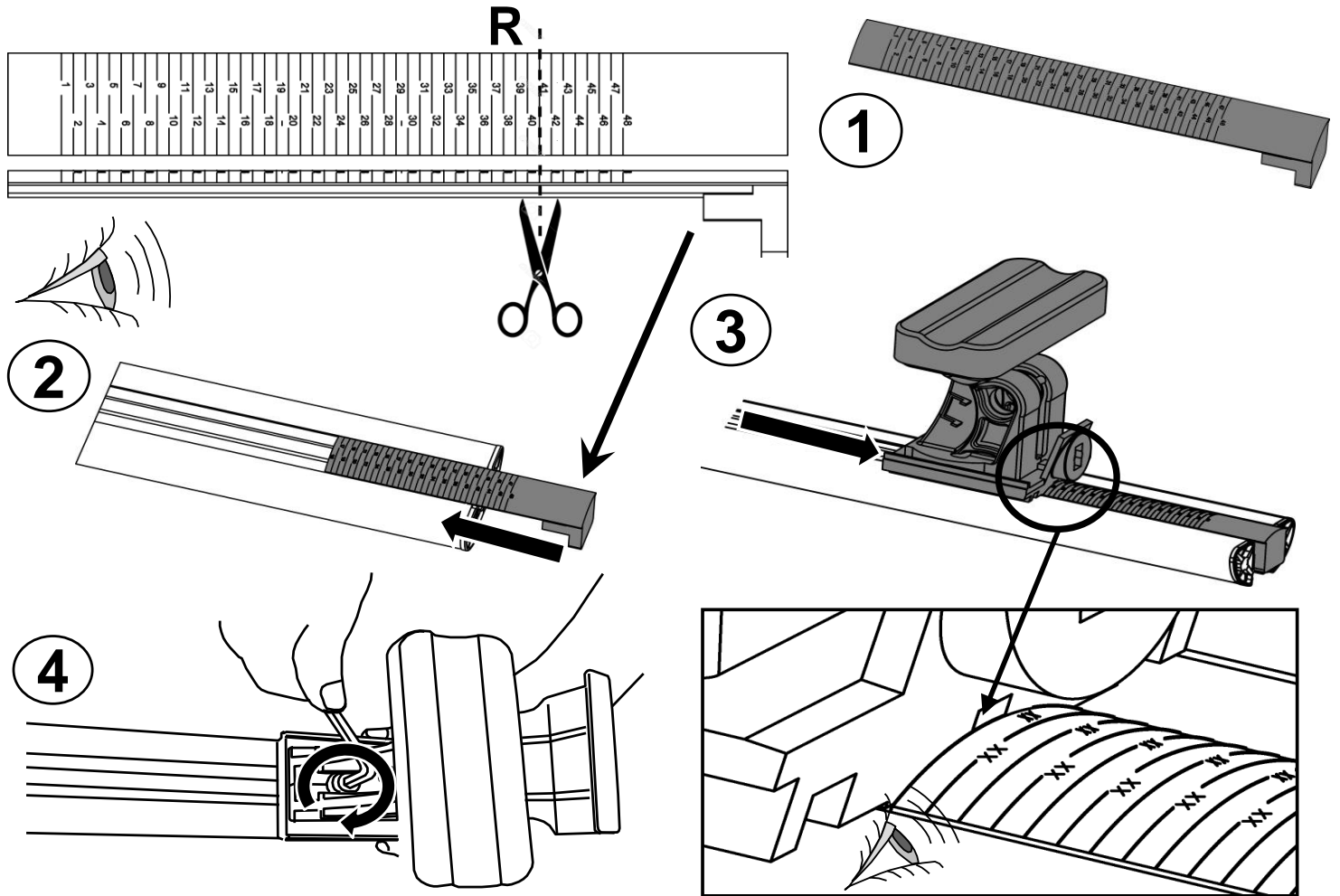

			<b>R</b>	<b>mm</b>
<b>FORD</b>	<b>KA+</b>	<b>5</b>	<b>R= 41</b>	<b>970</b>

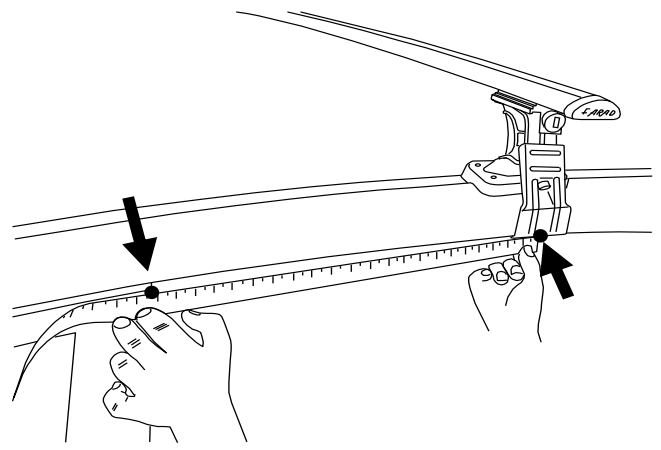
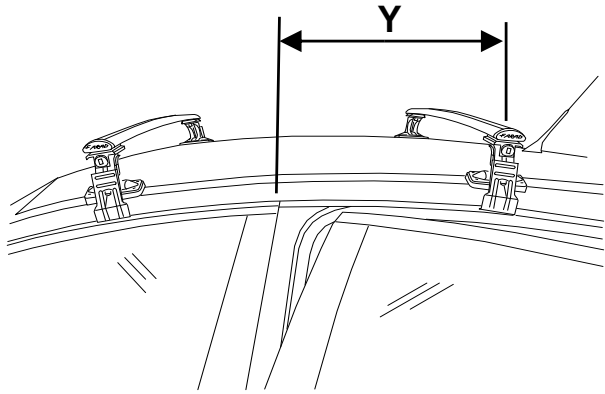
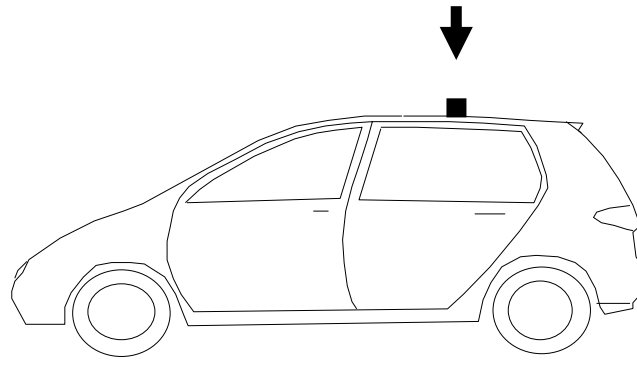

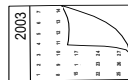

				<b>Y</b>
<b>FORD</b>	<b>KA+</b>	<b>5</b>	<b>2016&gt;</b>	<b>Y= 440</b>

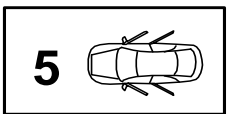

✓ **4 Nm**

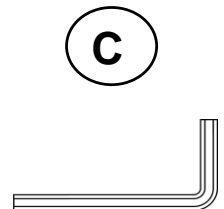
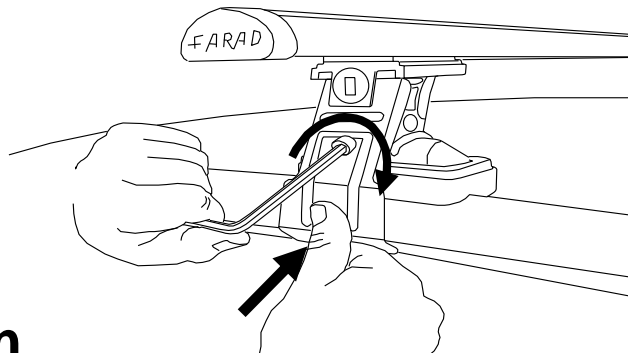



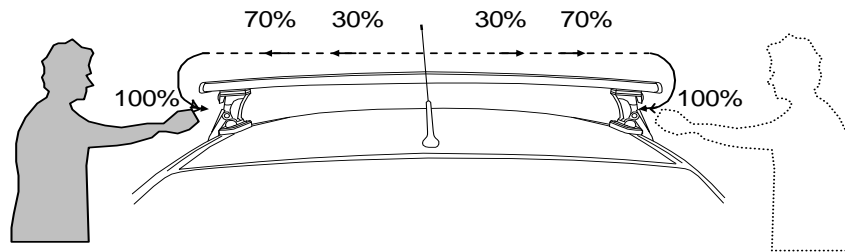

- |    |   |     |                                    |
|----|---|-----|------------------------------------|
| I  | Alternare il fissaggio delle viti                       | F   | Serrer alternativement chaque côté |
| PL | Śruby dokręcaj naprzemiennie                            | D   | Die Schrauben abwechselnd anziehen |
| GB | Tighten alternately                                     | E   | Apretar alternativamente           |
| NL | Afwisselend aan de linker- en de rechterkant aandraaien | SWE | Dra åt växelvis                    |

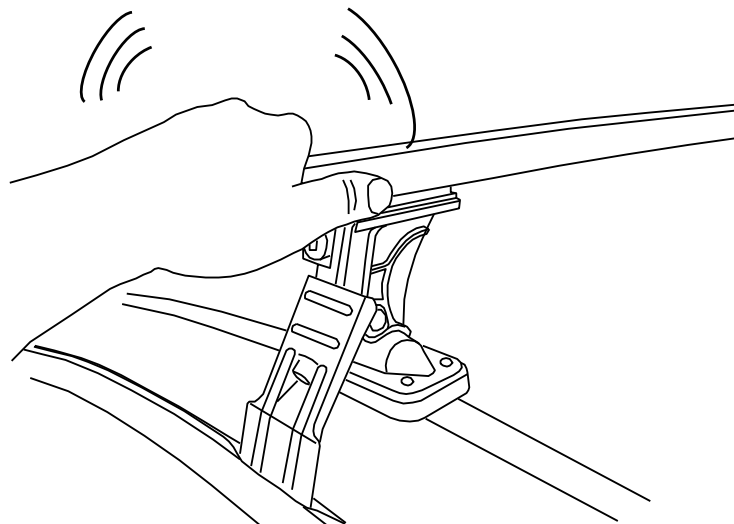
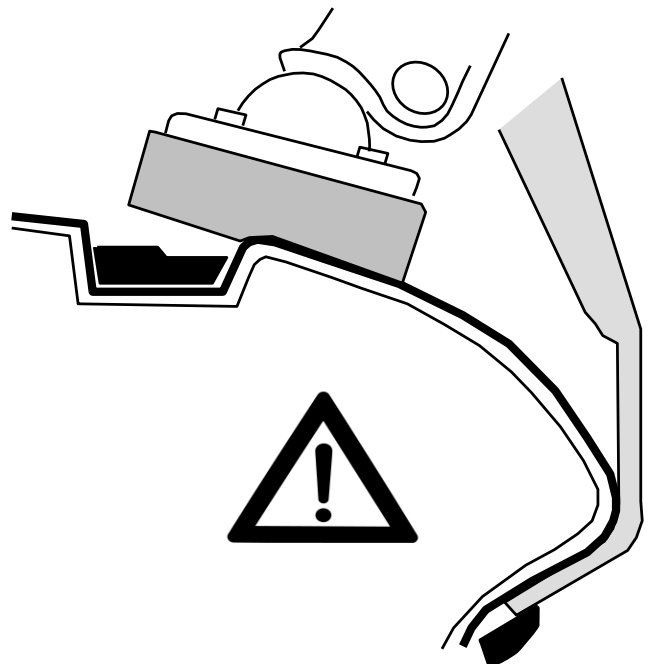
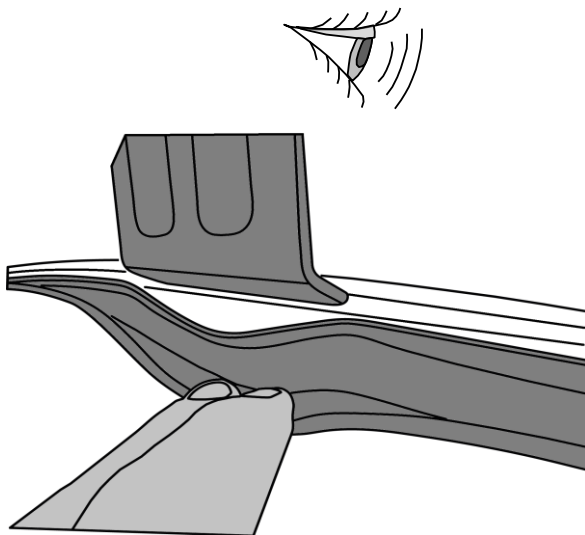
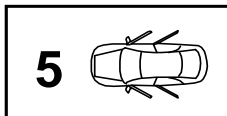

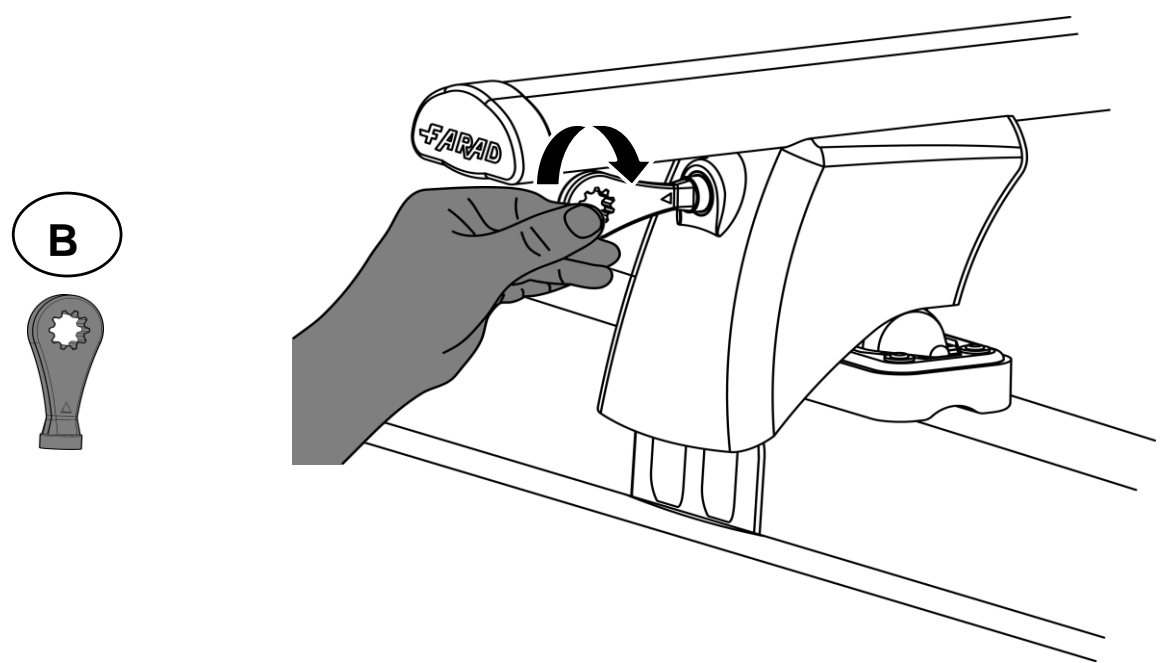
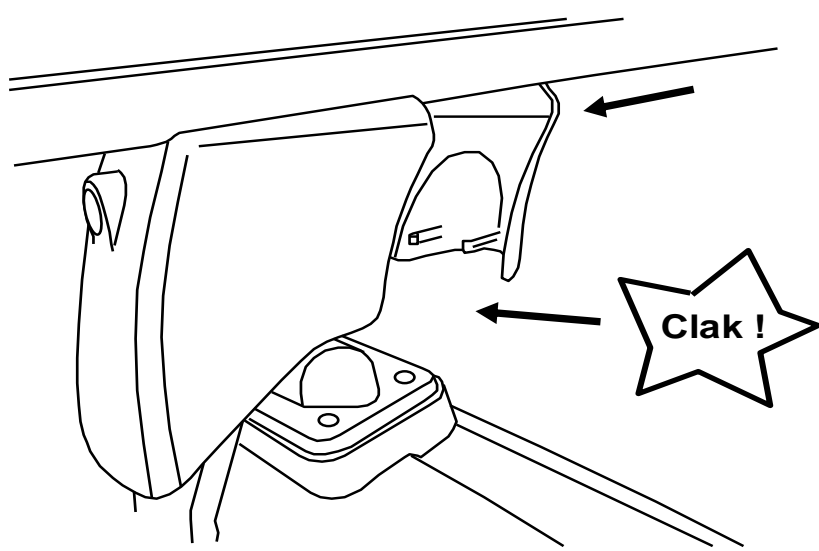
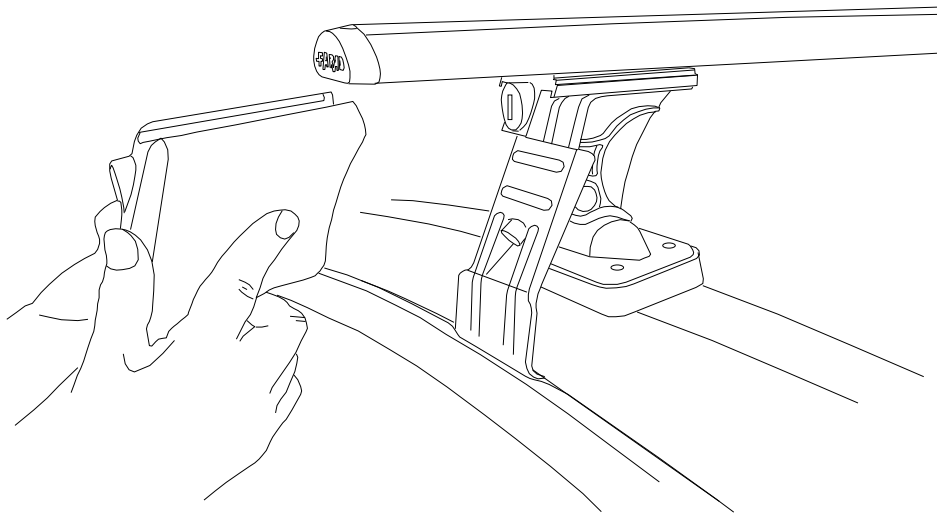

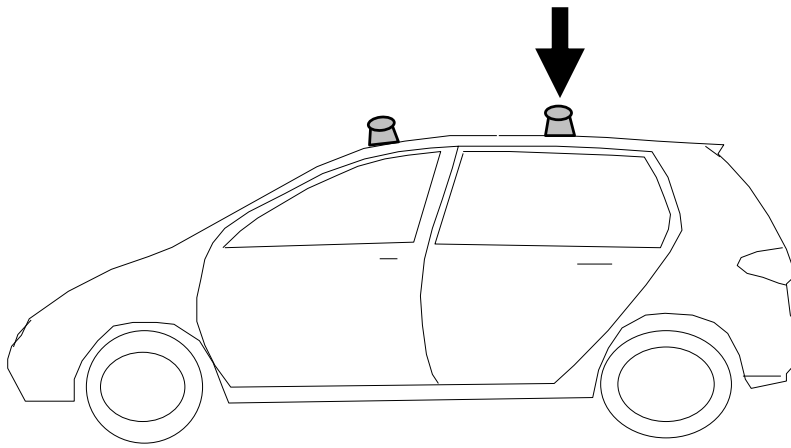

- I** CONTROLLARE PERIODICAMENTE IL FISSAGGIO DELLE VITI
- PL** OKRESOWO SPRAWDZAJ MOCOWANIE ŚRUB
- GB** CHECK THE SCREW FASTENING PERIODICALLY
- D** REGELMÄSSIG ÜBERPRÜFEN DIE BEFESTIGUNG DER SCHRAUBEN
- SWE** REGELBUNDET KONTROLLERA OM FASTSTÄLLANDE AV SKRUVARNA
- F** VERIFIEZ LA FIXATION DES VIS PERIODIQUEMENT

# RICAMBI - SPARE PARTS



PIEDE GIREVOLE  
90341 / 2

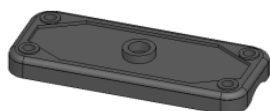

PIEDE FISSO  
90341 / 15

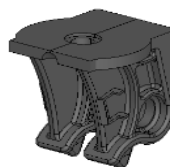

SUPPORTO CENTRALE  
90341 / 1

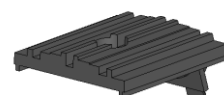

SUPPORTO BARRA  
90341 / 5



SOTTO PIEDE SP01  
90341 / 3



SOTTO PIEDE SP03  
90341 / 16



SOTTO PIEDE SP04  
90341 / 13



SOTTO PIEDE SP07  
90341 / 11



SOTTO PIEDE SP08  
90341/14



SOTTO PIEDE SP10  
90341 / 12



SOTTO PIEDE SP12  
90341 / 1



CHIAVE ESAGONALE 6  
9331 / 148

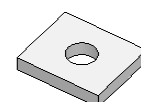

PIASTRINA  
90341 / 21



DISTANZIALE  
90341 / 20



NOTTOLINO + N° COMB.  
90341 / 6



SOTTOTAPPO  
90241 / 9



TAPPO BARRA  
90241 / 6

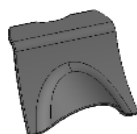

INVOLUCRO POST.  
90341 / 9

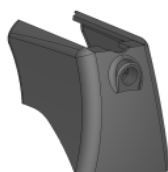

INVOLUCRO ANTERIORE  
90341 / 8



CHIAVE + N° COMB  
90341 / 7



PALETTA  
90341 / 4



BARRA ALLUMINIO  
90241 / 7



GUARNIZIONE BARRA  
90241 / 8



RIGA CARTA  
90341 / 19



PERNO  
90241 / 15

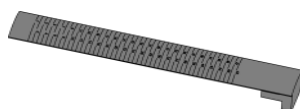

GUARNIZIONE  
NUMERICA  
91141 / 14

**FARAD**<sup>®</sup>  
made in italy

tel. 011 9713719 - n° verde 800984229  
[www.faradworld.com](http://www.faradworld.com)